

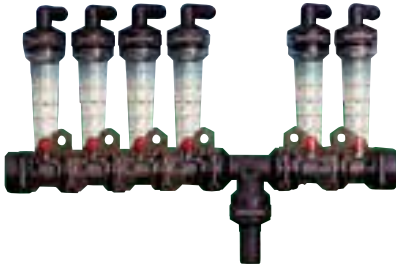

Manifold Flow Indicators

- Each flow indicator supplies up to three nozzles.
- Indicator balls hover at about same height when functioning properly,
- A ball hovering at a lower height than the others indicates flow restrictions such as plugged tip.



Boom Set Up

Above example 6-section boom set up requires the following parts:

- 6 x 20460-00 Flow Assemblies
- 6 x 205**-00 Elbows (indicate size)
- 2 x 20521-00 Cap
- 1 x 20522-00 Tee
- 1 x 205**-00 (indicate size)

Isolated Feed Indicators

- Designed for single line applications – each unit fed from bottom, outlet port at top.
- Unique offset body configuration allows units to be “ganged” together into a bank as required.
- Quarter-turn Radialock inlet fittings enable quick assembly or removal.



Boom Set Up

Above example 3 body boom set up requires the following parts:

- 3 x 20480-00 Flow Assemblies
- 3 x 205**-00 Elbows (indicate size)
- 3 x 404**-00 Radialock Hose Barb (indicate hose barb size)
- 1 x 40260-00 O-ring Seal



Metering Orifices

Metering orifices can be inserted in place of the flow indicator ball retainer and utilized to control flows ranging from 0.004 to 8.0 US gallons per minute.

PART	DESCRIPTION	PRICE (B)
21000-00	Blank	.95
21025-00	.025	5.95
21055-00	.055	5.95
21104-00	.104	5.95
21250-00	.250	5.95

Call Even-Spray for orifice selection information.

Flow Indicator Balls

Standard Flow Rates; based on water.

PART	DESCRIPTION	PRICE (B)
20460-09	Black Plastic – .03 to .09 US GPM	.95
20460-08	Green Plastic – .05 to .18 US GPM	.95
20460-07	Red Plastic – .09 to .30 US GPM	.95
20460-06	Red Glass – .31 to .72 US GPM	.95
20460-05	½” Stainless Steel – .40 to 1.33 US GPM	1.95



Manifold Flow Indicator Assembly

Comes with 1 body, 1 ball retainer, 2 locking clips, 1 O-ring, 4 indicator balls (black, green, red, ½” SS).

PART	DESCRIPTION	PRICE (B)
20460-00	Mani Flow Assembly	26.80

Individual Parts

PART	DESCRIPTION	PRICE (B)
20460-01	Mani Std. Flow Body	16.60
20460-02	Ball Retainer	.80
20460-03	O-ring BUNA-N	.40
20460-04	U Locking Clip - SS	2.10



Isolated Flow Indicator Assembly

Comes with 1 body, ball retainer, 1 locking clip, 3 indicator balls (green, red, ½” SS).

PART	DESCRIPTION	PRICE (B)
20480-00	Iso Flow Assembly	21.10



90° Elbow

PART	DESCRIPTION	PRICE (B)
20520-00	90° Elbow	7.70



Cap / Fitting Assembly

PART	DESCRIPTION	PRICE (B)
20521-00	Cap	4.15
20535-00	Female x ¼” FNPT	4.35
20536-00	Female x ⅜” FNPT	4.35
20537-00	Female x ½” FNPT	4.35



Straight Fittings

PART	DESCRIPTION	PRICE (B)
20501-00	⅜” Hose Barb	3.65
20502-00	½” Hose Barb	3.65
20503-00	¾” Hose Barb	3.65



Elbows

PART	DESCRIPTION	PRICE (B)
20511-00	⅜” Hose Barb	3.65
20512-00	½” Hose Barb	3.65
20513-00	¾” Hose Barb	3.65

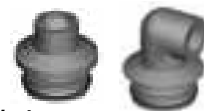

¼” Adapter

PART	DESCRIPTION	PRICE (B)
20518-00	¼” Elbow Adapter	3.65
20519-00	¼” Straight Adapter	3.65



Push-In Tube Connector Elbows

Friction-fit style hose 90° connectors

PART	DESCRIPTION	PRICE (B)
20516-00	¼” Hose x Elbow	6.40
20517-00	⅜” Hose x Elbow	7.10



1” Tee

Comes with ¼” FNPT gauge port; must be drilled to open flow to the gauge.

PART	DESCRIPTION	PRICE (B)
20525-00	1” Tee	9.70



Tees

PART	DESCRIPTION	PRICE (B)
20522-00	Tee	9.70
20523-00	Tee Blind at Female	8.10



Banjo Flow Meter Features:

- Displays overall total volume and batch total volume!
- Flow rate allows for Gallons or Litres Per Minute.
- The display reads 6 digits for Rate, 8 digits for Total, and 1 decimal reading in tenths.
- Magnetic style meter with Stainless Steel Electrodes.
- Self calibrating meter.
- Measures water and most conductive liquids.
- Operates on six (6) easy-to-change AA batteries.
- Reliable - No moving parts to fail during operation.
- Durable - Glass-reinforced polypropylene
- Temperature range from 0° F to 150° F (-17° C to 65° C).
- **NOTE: It is recommended to have at least 24 inches of straight pipe before and after the flow meter to ensure desired performance.**



FM100 1" Full Port Female NPT Flow Meter

- Accuracy is 99% from 2 to 110 GPM.

PART	DESCRIPTION	PRICE (F)
FM100	1" Full Port FNPT x FNPT Flow Meter	1602.05



MFM100 1" Full Port Manifold Flow Meter

- Accuracy is 99% from 2 to 110 GPM.

PART	DESCRIPTION	PRICE (F)
MFM100	1" Full Port Manifold x Manifold Flow Meter	1602.05



MFM220 2" Full Port Manifold Flow Meter

- Accuracy is 99% from 6 to 300 GPM.

PART	DESCRIPTION	PRICE (F)
MFM220	2" Full Port Manifold x Manifold Flow Meter	1820.30



MFM300 3" Full Port Manifold Flow Meter

- Accuracy is 99% from 14 to 670 GPM.

PART	DESCRIPTION	PRICE (F)
MFM300	3" Full Port Manifold x Manifold Flow Meter	2284.60

Chemtraveller



Shown with Optional Meter

435 Series Chemtraveller Diaphragm Pump – 12V or 115V

- 12 VDC ¼ HP (20 amps) or 115VAC ¼ HP (2 amps).
- Reciprocating spring-driven dual diaphragm design (positive displacement / (self-priming).
- Glass-filled polypropylene pump.
- Polypropylene, Santoprene®, and stainless steel internal wetted parts.
- Cast metal, spray-coated motor.
- Handles viscosities from 1 cps. to 3,000 cps.
- Flow rate: 13 GPM (1.5 cps. fluid); 11 GPM (350 cps. fluid).
- Particulate tolerance up to 1/10" diameter.
- 1" Female NPT Inlet / Outlet.
- 15 PSI Maximum outlet pressure.
- 9" dry vacuum (pump may run dry without damage).
- Maximum shear (agitation) of pump fluids.
- 14" x 8 ¾" x 4 5/8"; 15.5 pounds (7.03 kilograms)
- Inlet strainer required, must be ordered separately.
- 5-Year Warranty on Pump; 1-year Warranty on Meter

PART	DESCRIPTION	PRICE (F)
435	12 Volt Chemtraveller Less Meter	1749.90
465-713	115 Volt Chemtraveller – less Meter	2003.00



850 Series Meter

- Air sensing Digital Flow Meter with 1" FNPT ports.
- Air sensing feature stops misreads caused by foam or air in lines.
- Flow Range: 2 – 20 US GPM; Maximum Pressure: 120 PSI.
- Accurate to +/- 0.2%.
- Calibrates in ounces, pints, quarts, litres, gallons; special option available
- Range: 9,999 current total; up to 10,000,000 accumulated total.
- Glass-filled polypropylene body; Ryton 302 stainless steel chamber.
- Easy-to-read LCD dial.
- Use at pump end or at hose end.
- Includes 2 "AA" batteries and pocket-sized calibration chart.

PART	DESCRIPTION	PRICE (F)
850	Flow Meter with Air Sensor	572.20



825 Series Meter

- Non-Air sensing Digital Flow Meter with 1" FNPT ports.
- 20 stored settings to match a wide range of popular chemicals listed.
- Can be used with a range of liquids with different viscosities.
- Accurate to +/- 0.2%.
- Easy-to-read LCD dial; easy-to set up and use.
- Use at pump end or at hose end.
- Includes 2 "AA" batteries and pocket-sized calibration chart.

PART	DESCRIPTION	PRICE (F)
825	Flow Meter No Air Sensor	427.40



SF-1100-PTS

The SF-1100-PTS system comes with the FM-1100. Pump-mounted Flow Meter.

The **SHURflo AG Runner™** system is ready to take anywhere. The AG Runner™ is portable, flexible, and extremely versatile, especially for those that use multiple containers. The entire system is mounted in a sturdy, easy-to-carry, welded frame and includes:

- SF-1100 Chemical Transfer Pump with 12VDC Motor, 20 ft. cable, Alligator Clips, and in-line Fuse.
- FM-1100 (Pump Mount) or FM-1100-1 (In-line Mount) Flow Meter (features large LCD display, simple calibration, and long-life lithium batteries).
- 1" NPT x 12' EPDM Discharge Hose with Ball Valve / Spout.
- 1" NPT x 12' EPDM Inlet Hose with Elbow / Ball Valve / Fitting (1") assembly with Locking Cam Arms.
- Pump Performance: Maximum 15 PSI; 10.7 GPM; capable of priming up to 12 feet.

PART	DESCRIPTION	PRICE (E)
SF-1100-PTS	SHURflo AG Runner™ Transfer System - complete	1841.95
SF-1100	Stand Alone Pump with 20 ft. Cable	886.85
FM-1100-1	Inline Flow Meter	498.10